

Okta Verify and Fast Pass configuration for Windows

Okta Verify and Fast Pass configuration

PART 1**Configure Okta Verify (Fast Pass) desktop application****01****Launch Okta Verify**

- Open the Okta Verify application on your machine's desktop and click on Get started.

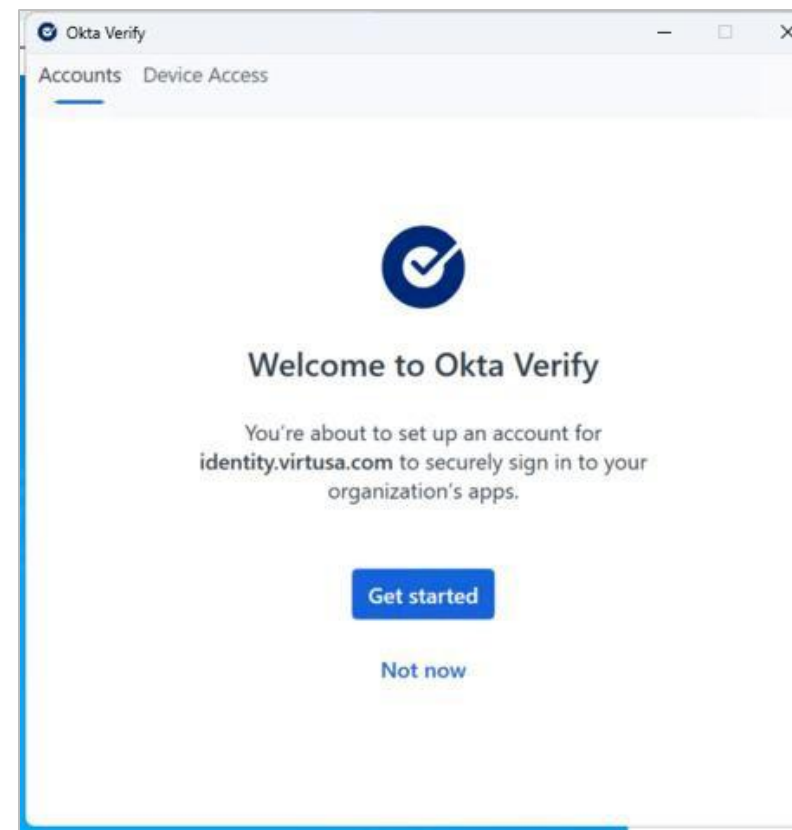

02

Begin account setup

- Click on next button to initiate the fastpass registration process.

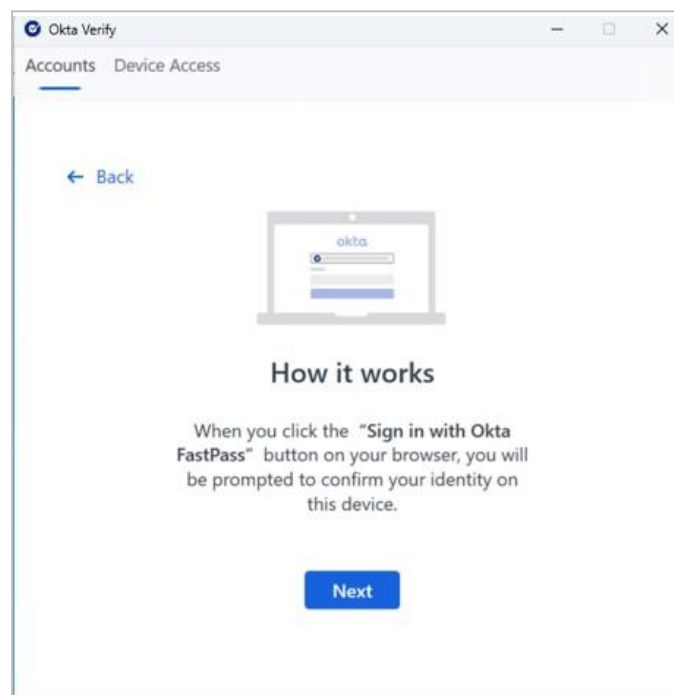

- This will initiate the browser session on your default browser.

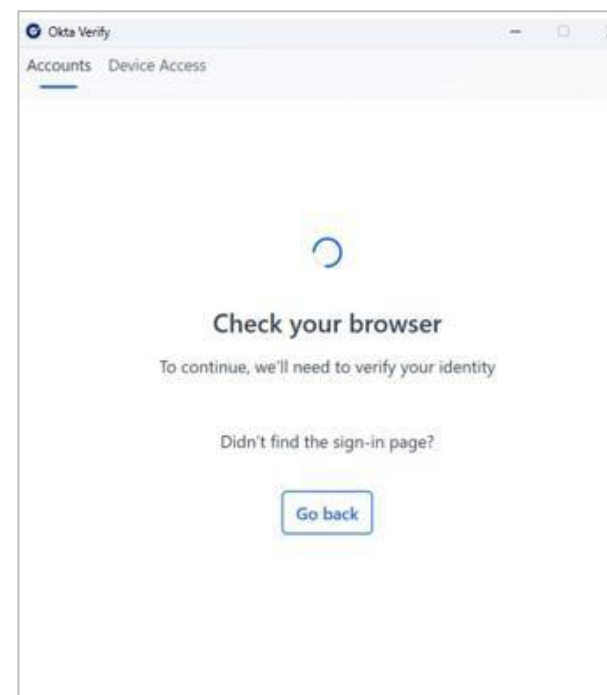

03

Authenticate for Fast Pass

- Browser will open the URL <https://identity.virtusa.com>
- Enter your email address to sign in to the Identity portal and click next.

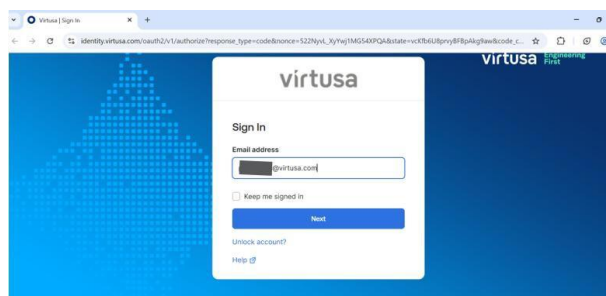

- Okta will prompt you to verify your identity by providing your password or okta verify Push notification or TOTP.

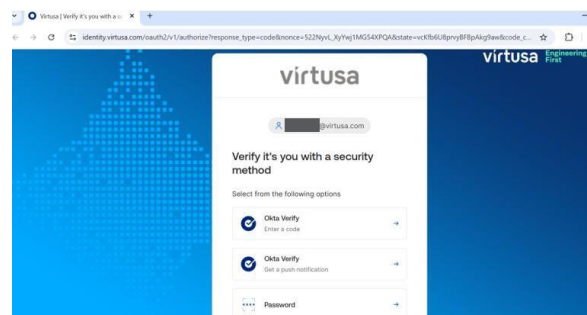

- Verify the session with any one of these methods to complete the authentication.

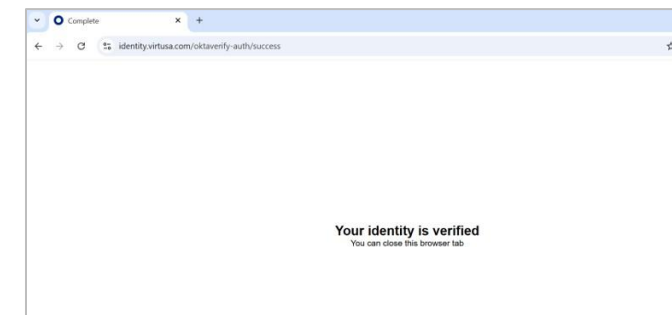

04

Enable Windows Hello configuration

- Click on the Enable button to initiate Windows hello configuration. This is required for application access. Hence this is mandatory to enable windows hello configuration.

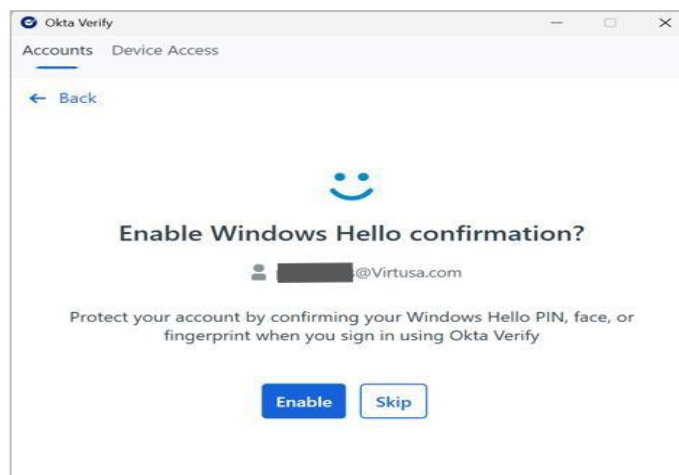

- Choose settings to start the configuration and click get started.

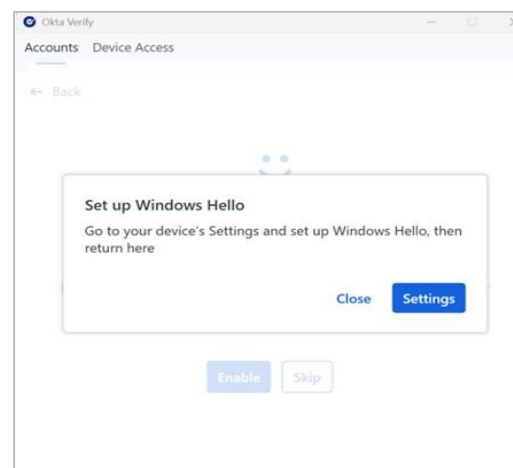

06

Configure PIN setup

- Enter the password for your account to initiate windows hello PIN configuration.

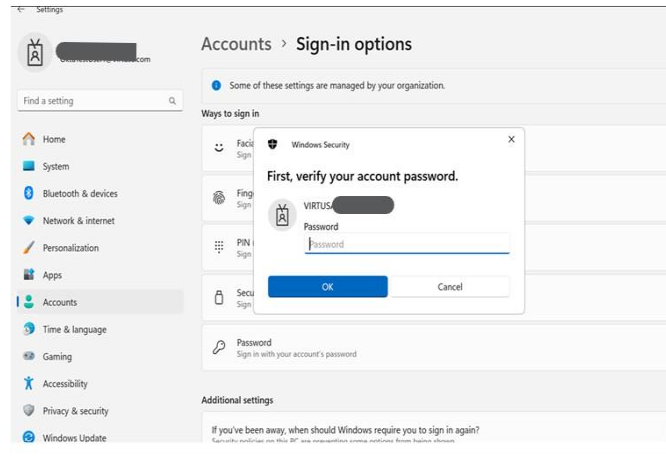

- Enter the PIN with below complexity.
 - Minimum 8 characters
 - Maximum 14 characters
 - Must have 1 upper case and 1 lower case letters
 - Must have 1 special character and 1 numeric.
 - It can't be a number pattern.

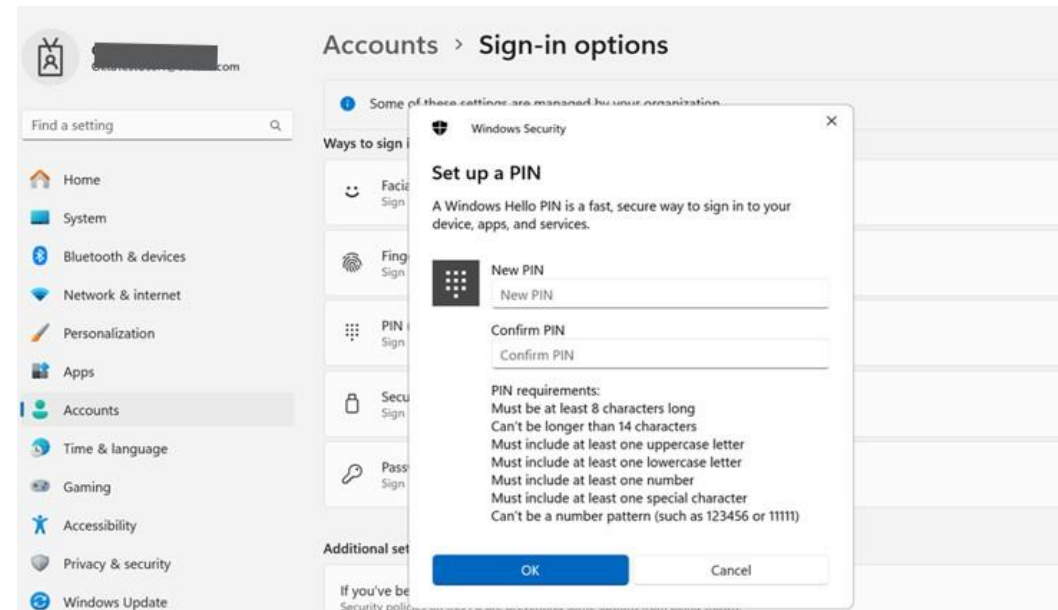

07

Configure fingerprint recognition (If applicable)

- Configure fingerprint recognition if your machines support them. Expand fingerprint recognition and click setup.

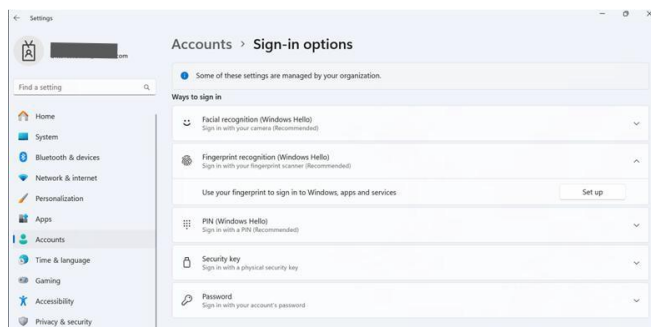

- Verify your identity by entering PIN.

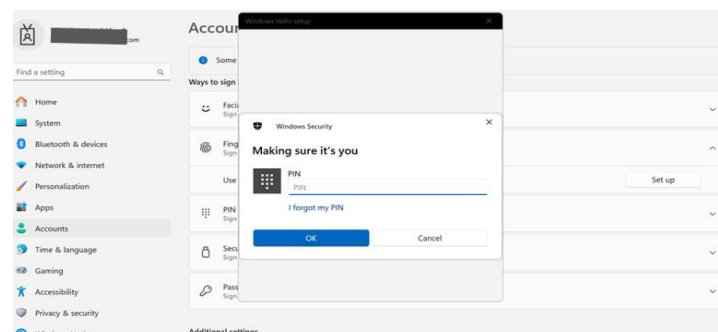

- Touch the fingerprint sensor in different angle as instructed to complete the finger print configuration and click close to complete the configuration.

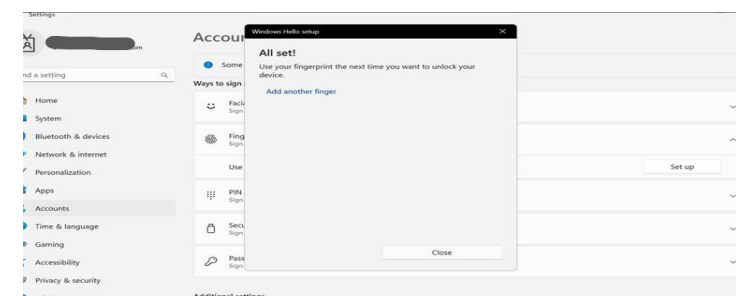
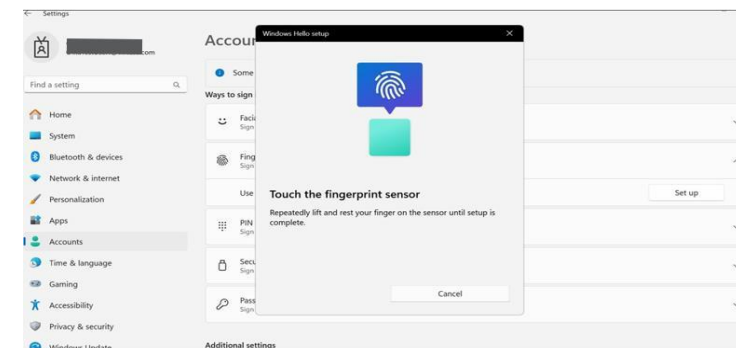

08

Finish the setup

- Okta fast pass with windows hello has been configured and machine is now configured for Okta authentication for accessing the applications.

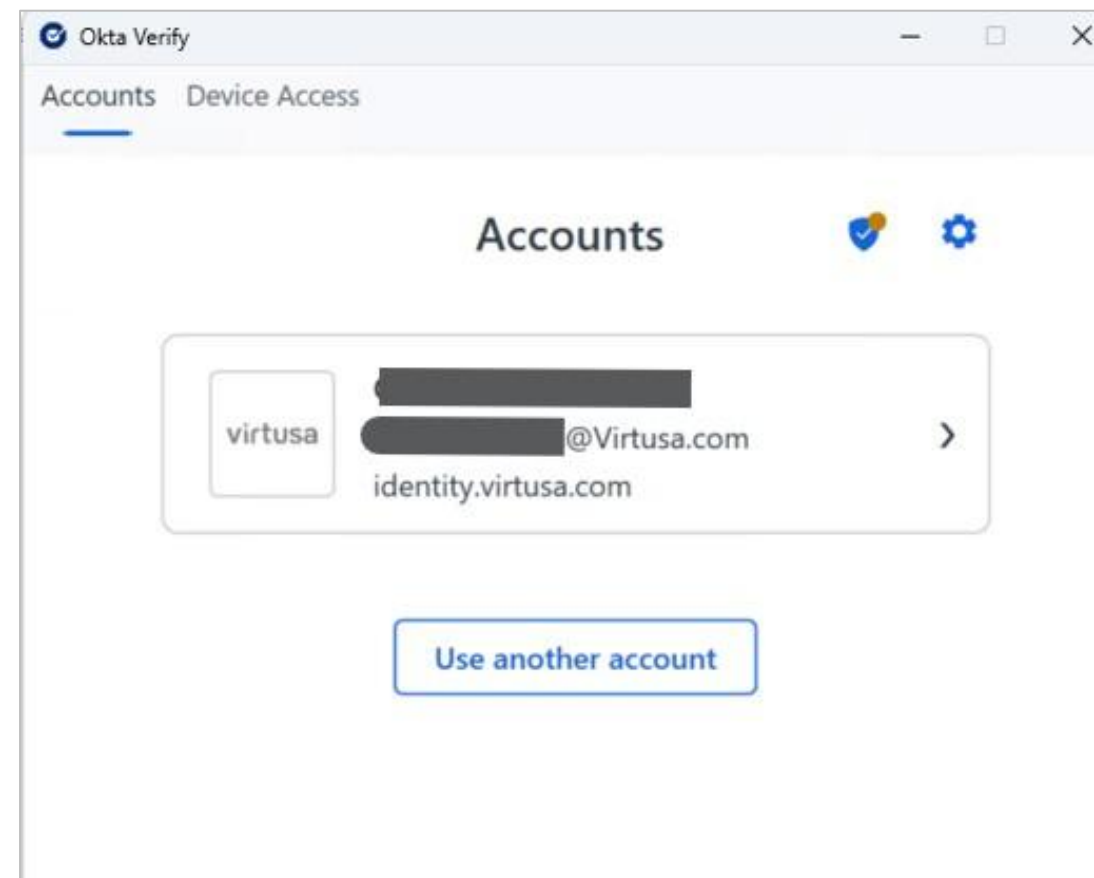

Okta Verify and Fast Pass configuration

PART 2

Okta Verify Offline OTP configuration

01

Select Device Access in the Okta verify application

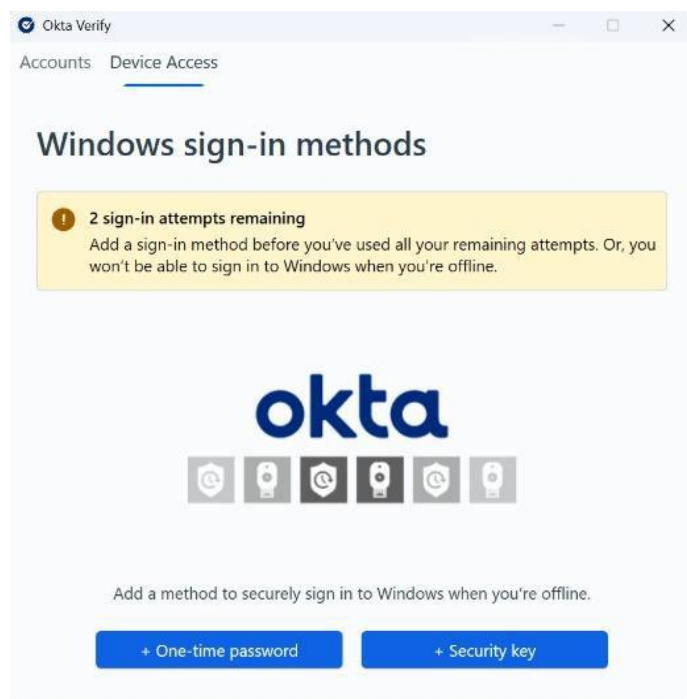

02

Click +one-time password

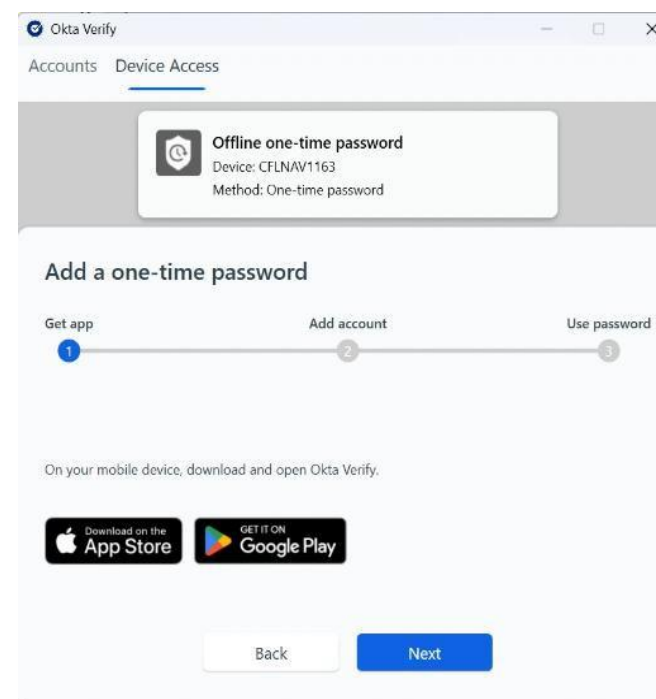

03

Click on Next and scan the QR code using okta verify in your mobile and click next.

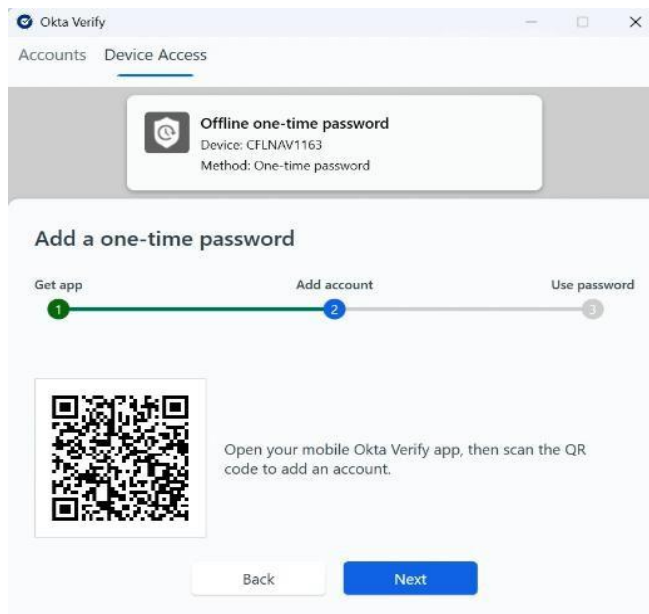

Okta Verify

Accounts Device Access

Offline one-time password
Device: CFLNAV1163
Method: One-time password

Add a one-time password

Get app 1 Add account 2 Use password 3

Open your mobile Okta Verify app, then scan the QR code to add an account.

Back Next

04

Enter the offline OTP which is available in the Mobile Okta verify and click next.

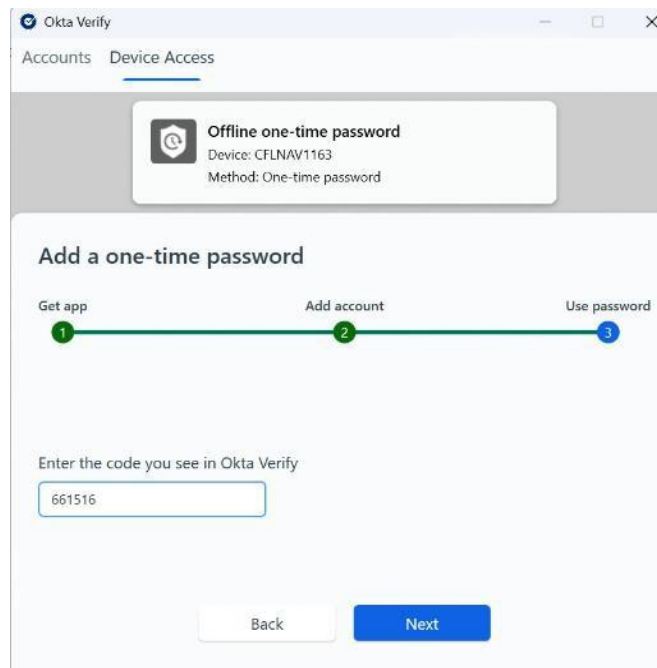

Okta Verify

Accounts Device Access

Offline one-time password
Device: CFLNAV1163
Method: One-time password

Add a one-time password

Get app 1 Add account 2 Use password 3

Enter the code you see in Okta Verify

661516

Back Next

05

Offline one time password will be configured for your laptop.

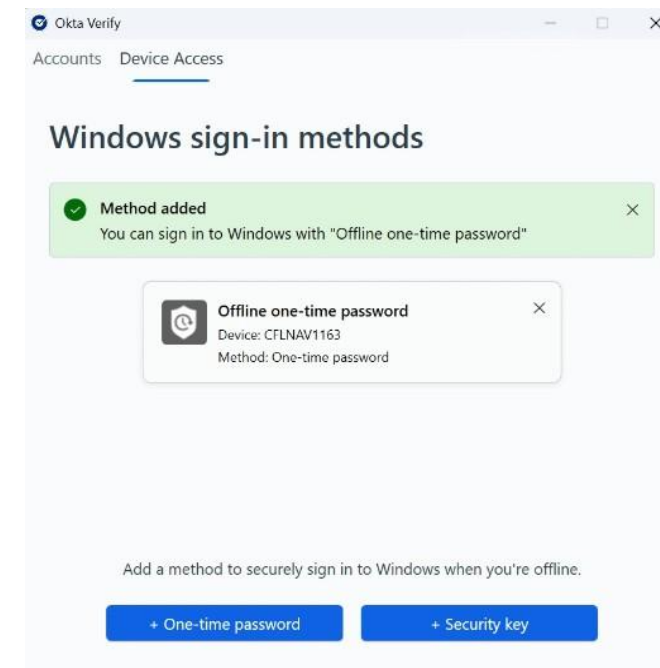

Okta Verify

Accounts Device Access

Windows sign-in methods

Method added
You can sign in to Windows with "Offline one-time password"

Offline one-time password
Device: CFLNAV1163
Method: One-time password

Add a method to securely sign in to Windows when you're offline.

+ One-time password + Security key

Login process

User can login with any of the 2 login process-Okta login or password login.

Password login (Windows OS)

Step 1:

Enter password by clicking sign-in options and select password button.

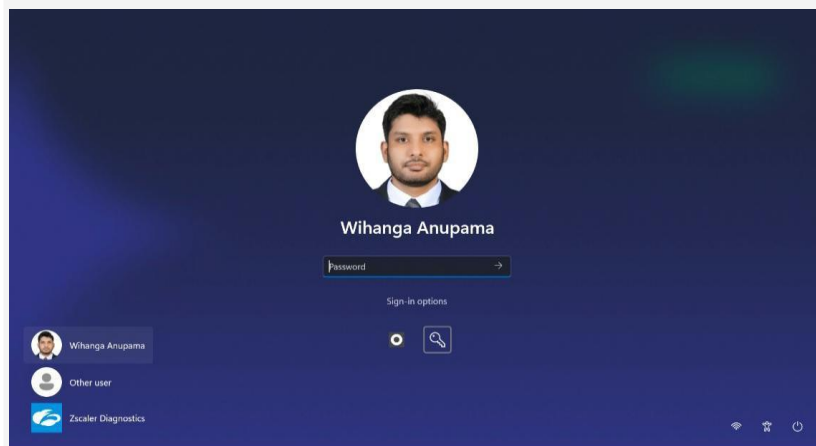

Okta login (Windows OS)

Step 1:

Click on **Sign in** button to get Okta push notification

Step 2:

Approve push notification which you have got in your mobile. You can also use **Okta Verify one-time password** or **Offline one-time password**.

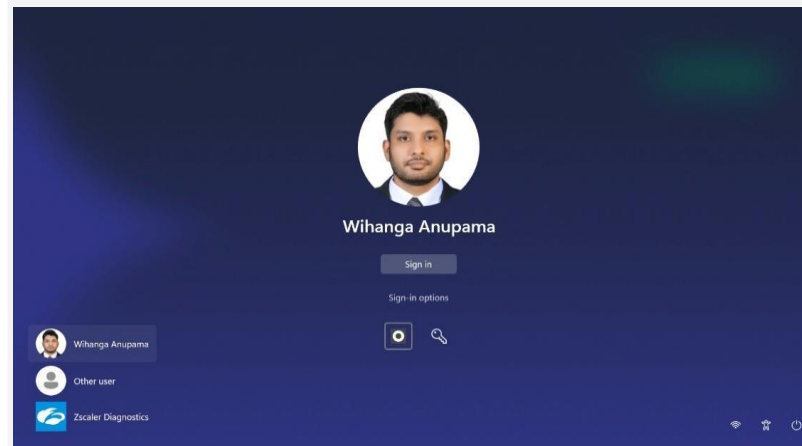

For additional information/issues, please reach out to [IT Service Desk](#) by logging a ticket.

Okta Verify and Fast Pass configuration for Mac OS

Okta Verify and Fast Pass configuration

PART 1**Configure Okta Verify (Fast Pass) desktop application**

01

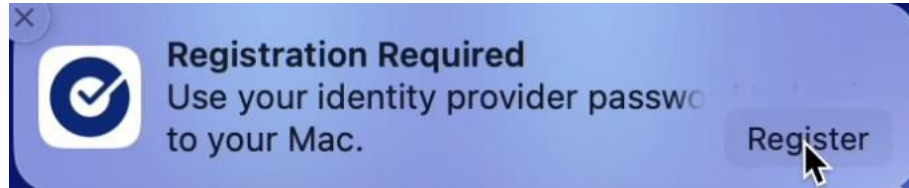

Alternatively, you may open the Okta verify app from the launchpad

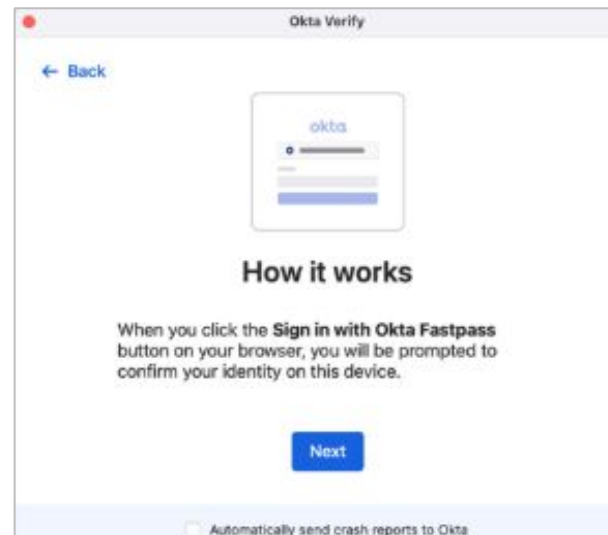
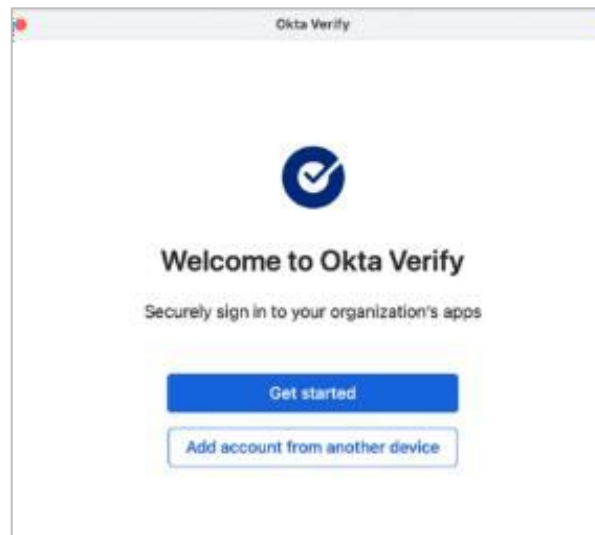

Note: Organization's sign-in URL will be auto filled

02

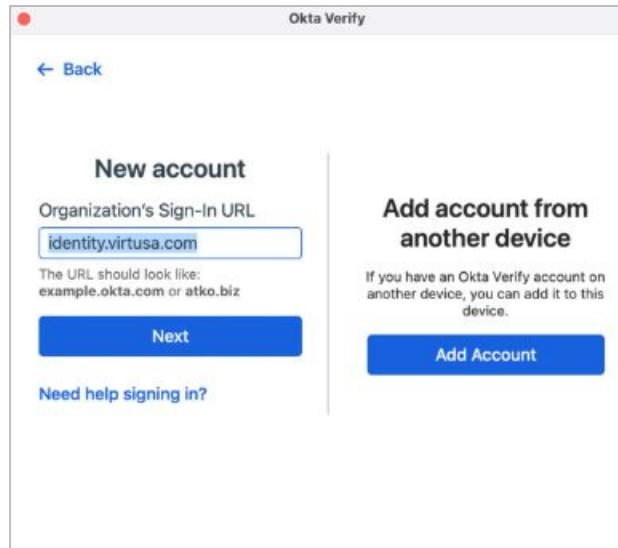

Okta Verify

← Back

New account

Organization's Sign-In URL

The URL should look like:
example.okta.com or atko.biz

Next

[Need help signing in?](#)

Add account from another device

If you have an Okta Verify account on another device, you can add it to this device.

Add Account

04

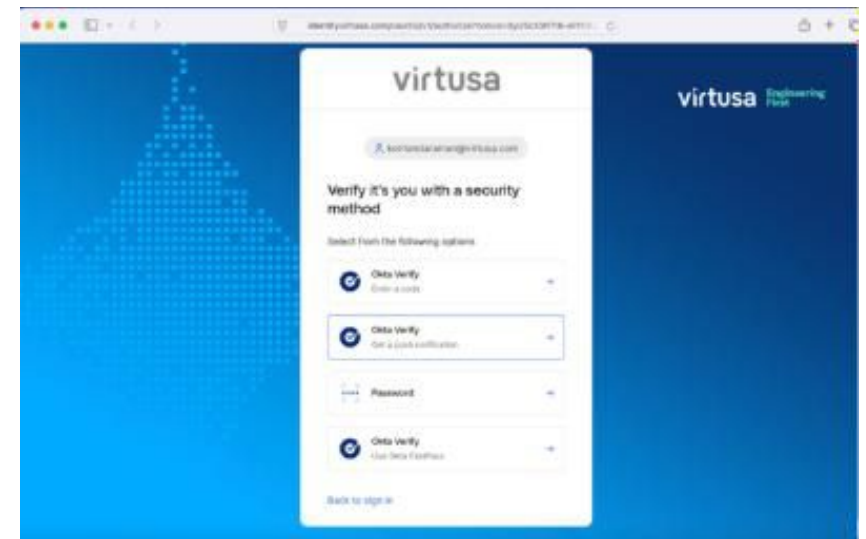

virtusa

virtusa Engineering First

Verify it's you with a security method

Select from the following options

- Okta Verify Enter a code
- Okta Verify Get a code push notification
- Password
- Okta Verify Use Secret Passcodes

[Back to sign in](#)

03

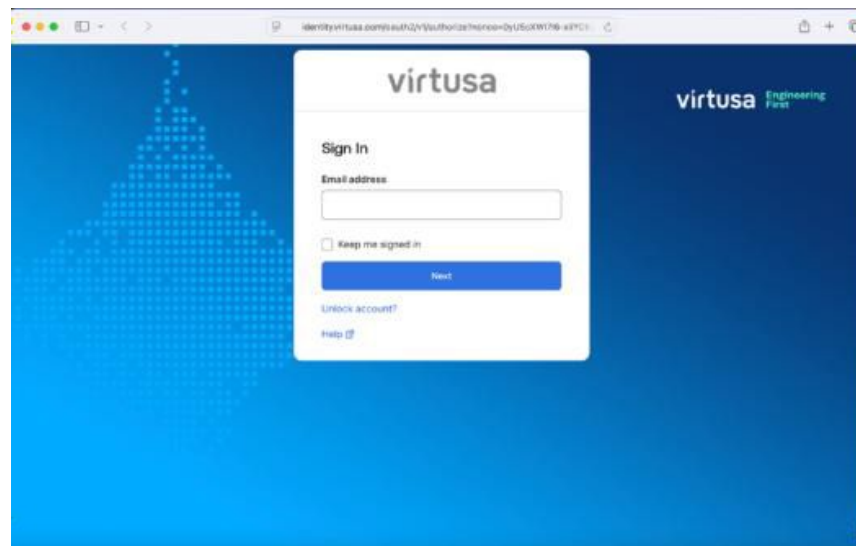

virtusa

virtusa Engineering First

Sign In

Email address

☐ Keep me signed in

Next

[Unlock account?](#)

[Help](#)

05

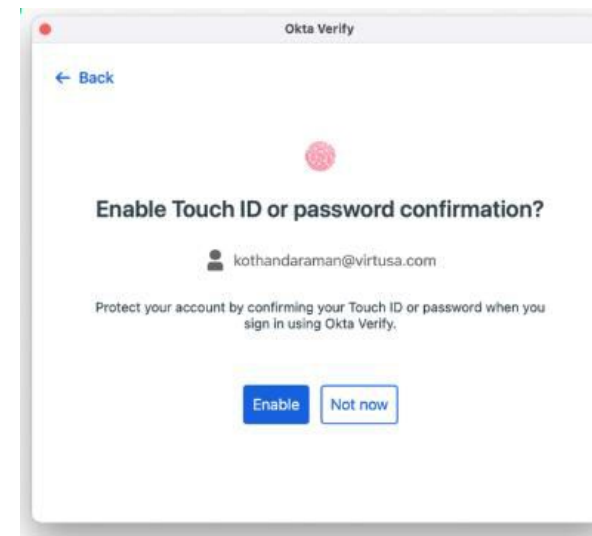

Okta Verify

← Back

Enable Touch ID or password confirmation?

 kothandaraman@virtusa.com

Protect your account by confirming your Touch ID or password when you sign in using Okta Verify.

Enable **Not now**

06

Configure platform single sign-on(Sync local and domain password)

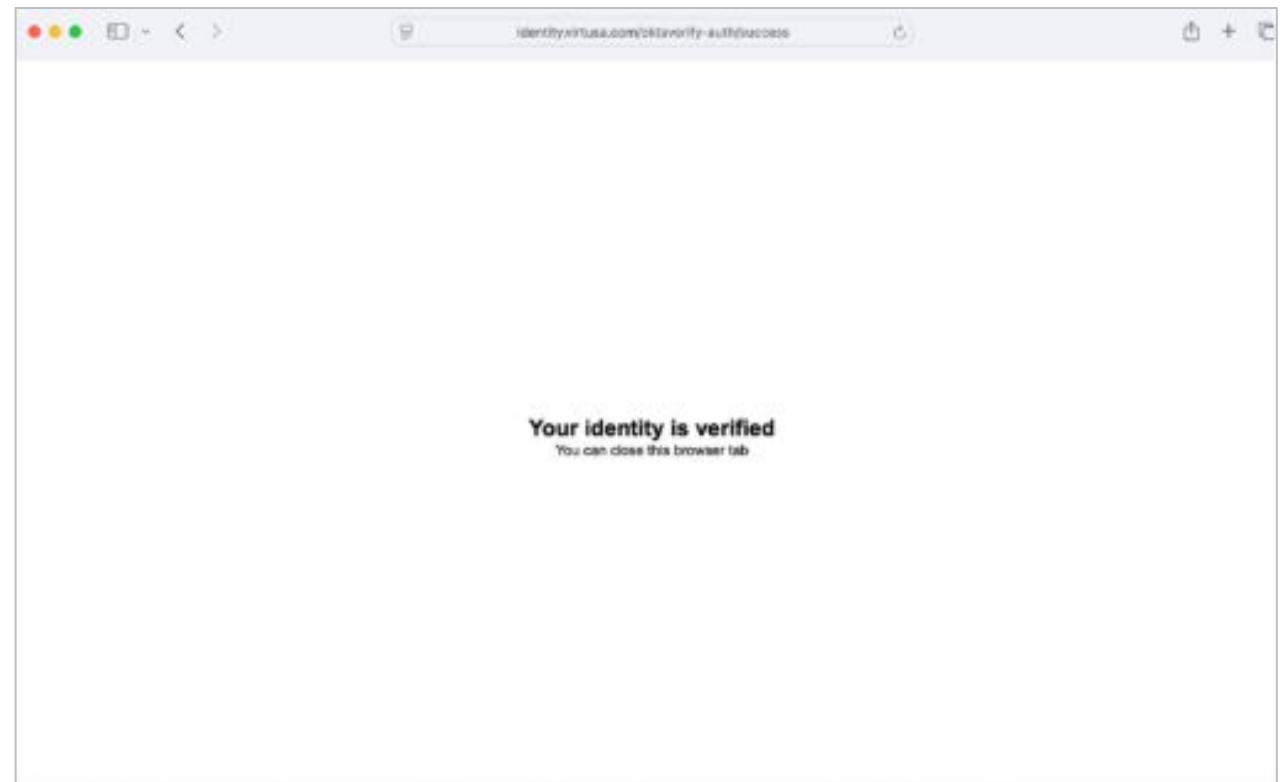
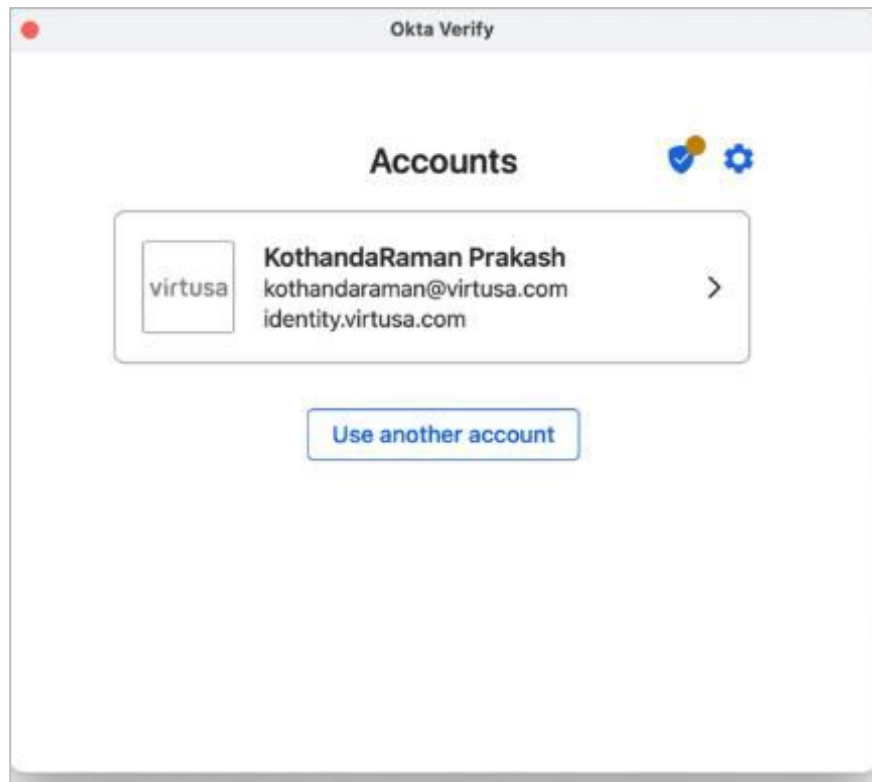

07

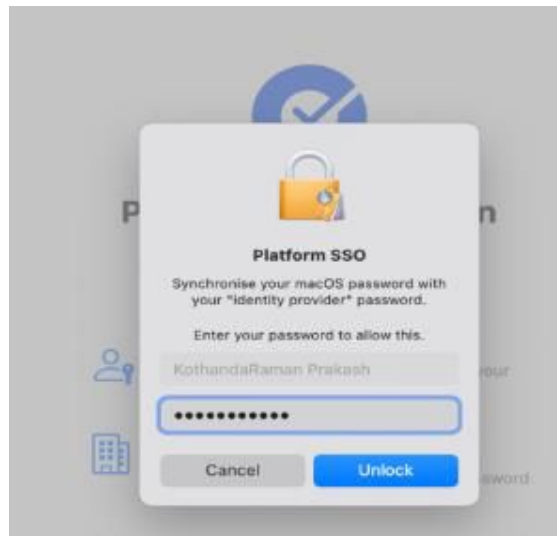
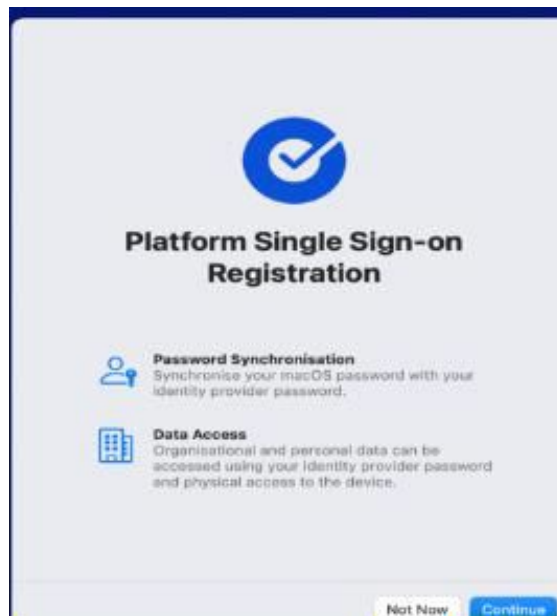

08

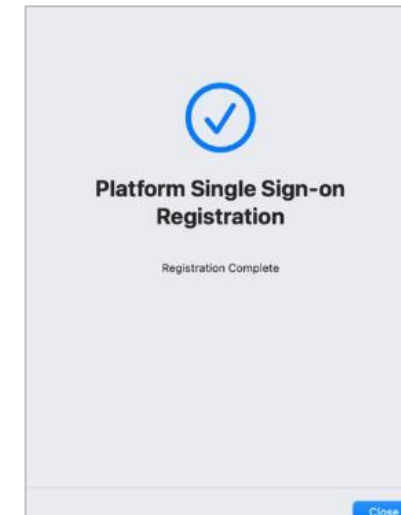
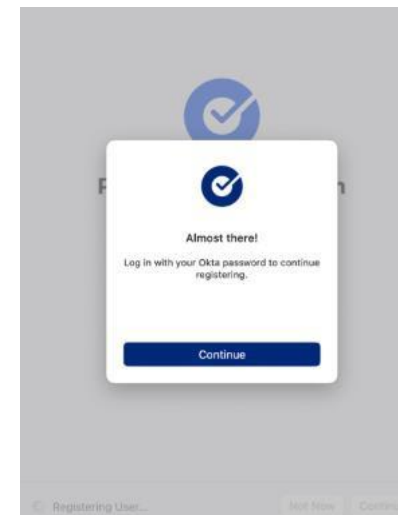
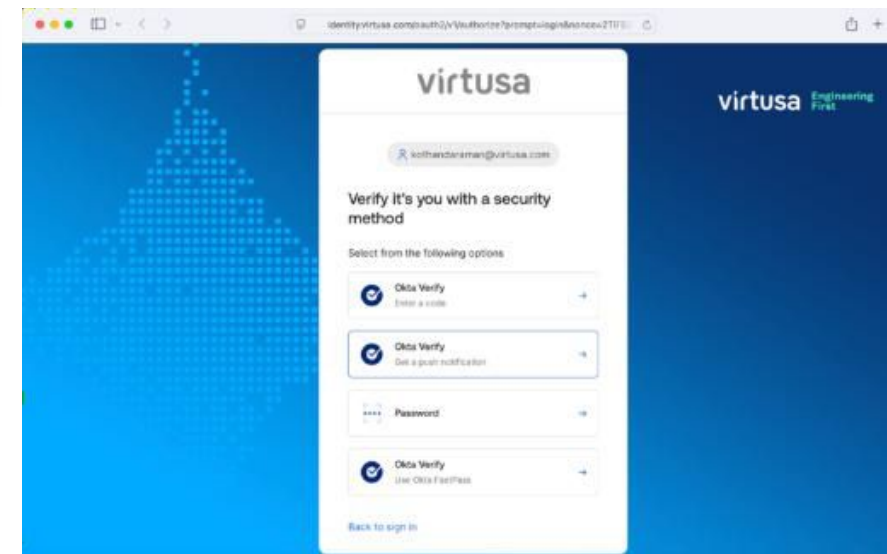

Configure Touch ID on macOS

Go to System Settings → Touch ID to enroll your fingerprint.

Note: Touch ID can be used for application authentication only. It is not supported for Mac login.

Thank You!